

existing building

# No. 12 PERRY STREET, MENINDEE NSW. (MENINDEE PUMP TRACK)

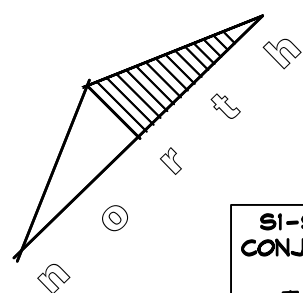

S1-S6. PROPOSED 6No. CONJOINED SHADE SAIL'S AS SHOWN. TO MANUFACTURER DESIGN & SPECIFICATIONS.

C1-C12 proposed 12No. various height column's to shade sail, as per manufacturer design & specifications.

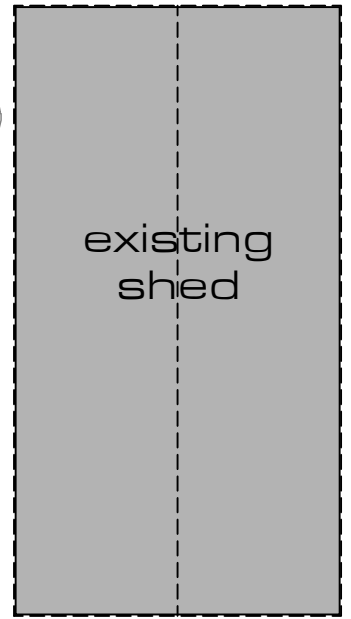
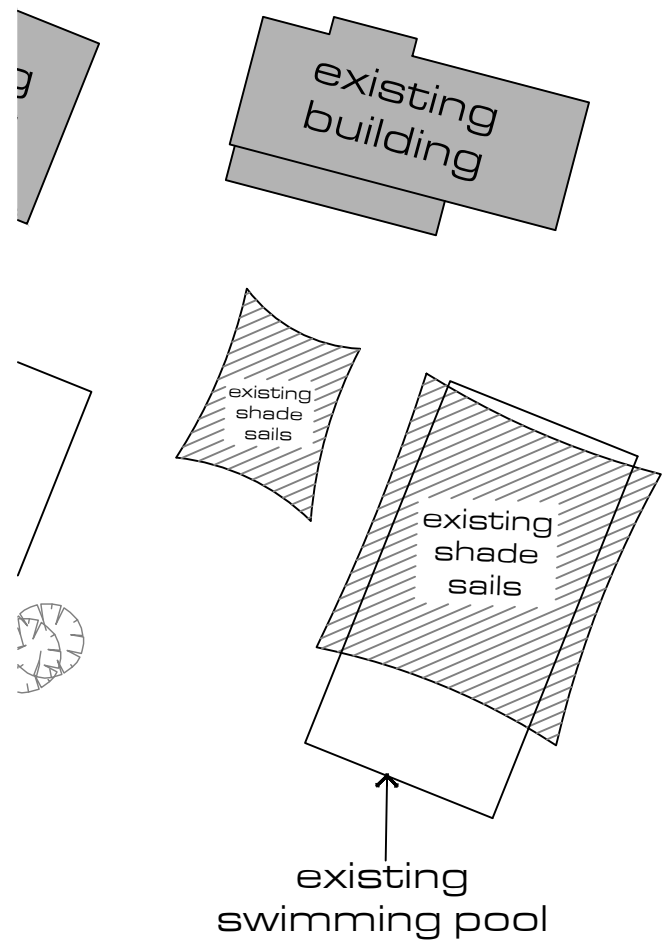
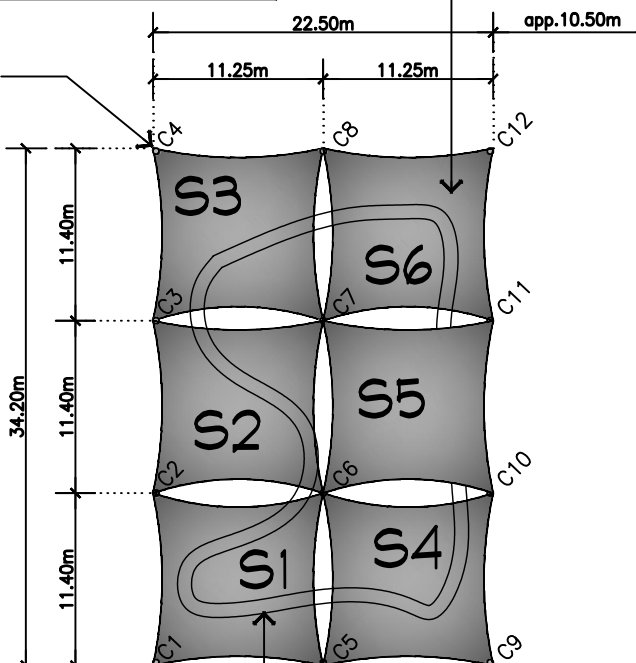

existing running track area

B O U R K E S T R E E T

existing building

## YARILA STREET SITE LAYOUT PLAN: SCALE: 1:500

SHEET NO: 1 OF 2  
PROJECT: PROPOSED 6No. SHADE SAIL STRUCTURE'S  
CLIENT: MENINDEE PUMP TRACK RECREATION AREA  
ADDRESS: No. 12 PERRY STREET, MENINDEE NSW.  
SCALE: AS SHOWN DATE: JULY 2024

CANDILLA STREET

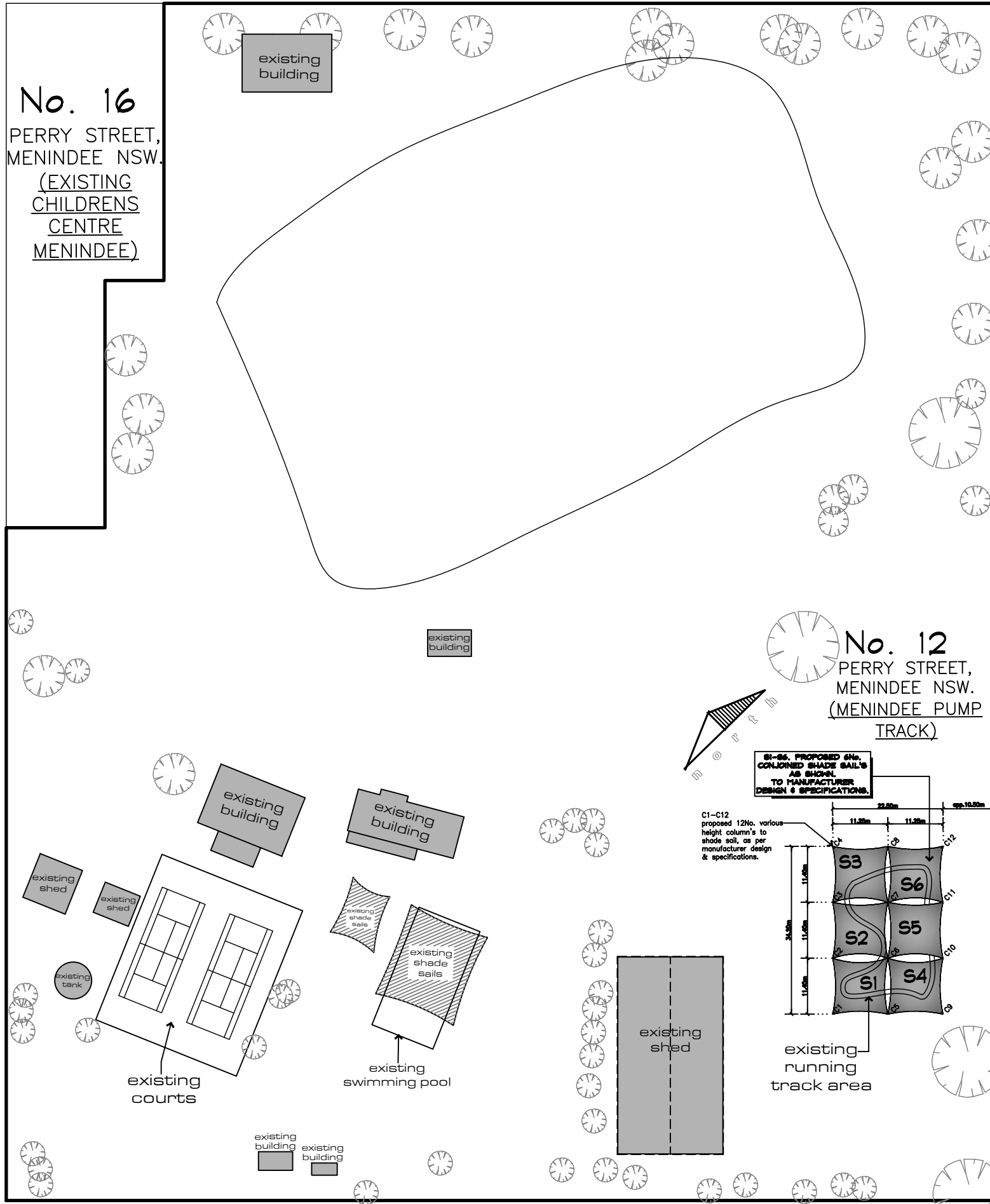

No. 16  
PERRY STREET,  
MENINDEE NSW.  
(EXISTING  
CHILDRENS  
CENTRE  
MENINDEE)

No. 12  
PERRY STREET,  
MENINDEE NSW.  
(MENINDEE PUMP  
TRACK)

MENINDEE STREET

MENINDEE STREET

# OVERALL SITE LAYOUT PLAN.

SCALE: NOT TO SCALE

PERRY STREET

BOURKE STREET

YARILA STREET

SHEET NO: 2 OF 2

PROJECT:  
PROPOSED 6No. SHADE SAIL STRUCTURE'S

CLIENT: MENINDEE PUMP TRACK  
RECREATION AREA

ADDRESS: No. 12 PERRY STREET,  
MENINDEE NSW.

SCALE: AS SHOWN DATE: JULY 2024

STANDARD MULTIPLE SHADE SAILS

